

**WARNING**

All repairs, adjustments and maintenance not described in the Operator's Manual must be performed by qualified service personnel.

10/07

**Model WEEDWACKER - 358791050 (THROTTLE/SHAFT)**

Diagram Reference Number	Part Description	Part Number
1	ASSEMBLY-THROTTLE CABLE	530059759
2	THROTTLE HSG. (RIGHT)	530057541
3	SCREW-THROTTLE HSG.	530016406
4	SCREW	530015814
5	ASSEMBLY-WIRE	530054183
6	THROTTLE HSG. (LEFT)	530059760
7	KIT-SWITCH	530069572
8	TRIGGER	530049107
9	ASSEMBLY-HANDLE (INCL. 10,11)	530058583
10	WINGNUT	530016152
11	BOLT	530015786
12	SCREW	530016319
13	KIT-UPPER SHAFT (INCL. 14)	530071791
14	SCREW	530016344
15	KIT-LOWER SHAFT	530071789
16	WINGNUT	530016152
17	BRACKET-SHIELD	530057554
18	GEARBOX	530096099
19	SHAFT-FLEX	530096218
20	SCREW	530016014
21	SCREW-ALIGNMENT	530015775
22	LINE LIMITER	530052286
23	SCREW-LINE LIMITER	530015814
24	BOLT	530015820
25	KIT-SHIELD ASSEMBLY (INCL. 22,23)	530071997
26	ASSEMBLY-TNG VII (INCL. 27,28,29,30,31,32,33)	537419206
27	HOUSING	537419302
28	ADAPTER	537419801
29	SPRING	537338801
30	ACCY.-SPOOL (INCL. LINE)	71-8595
31	EYELET	537419701
32	COVER	537419401
33	KNOB	537419601
NI01	OPERATOR MANUAL	545137205
NI02	DECAL-SHAFT WRANING	530057296
NI03	DECAL-WRANING	530056220
NI04	BULB-PURGE	530058709

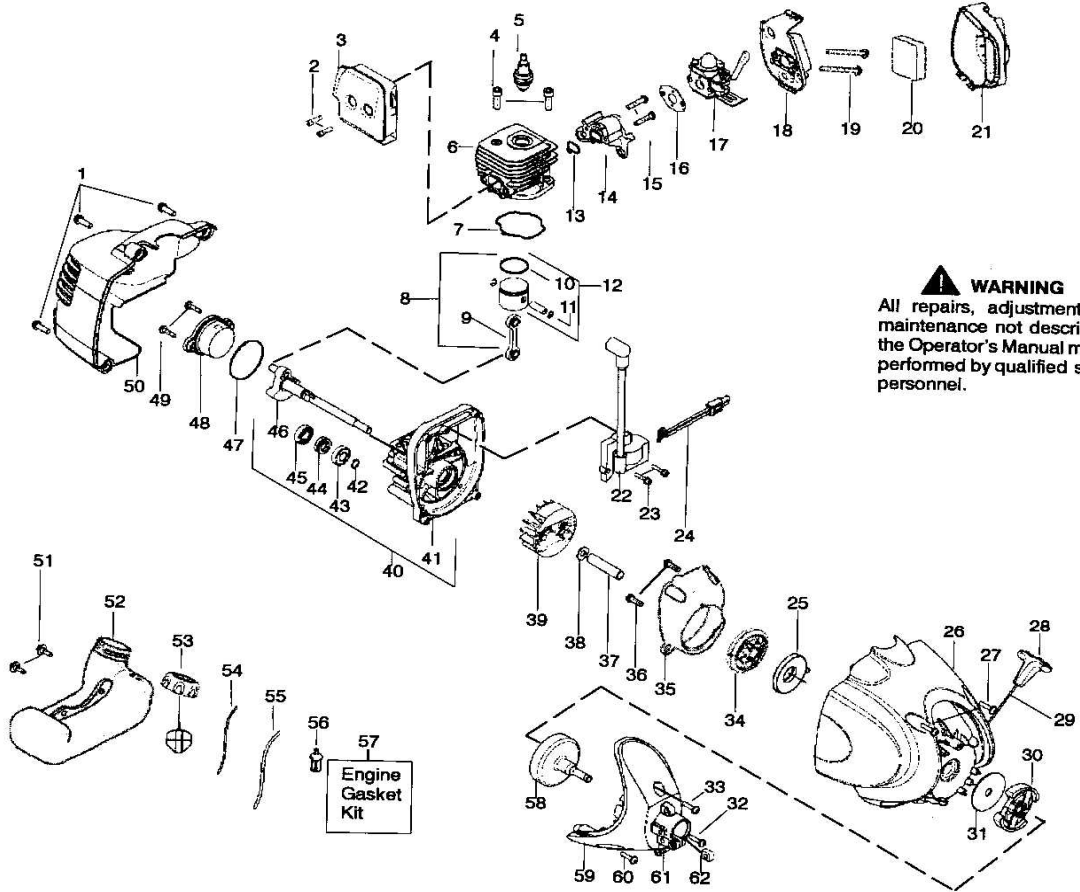

**WARNING**  
 All repairs, adjustments and maintenance not described in the Operator's Manual must be performed by qualified service personnel.

**Model WEEDWACKER - 358791050 (MUFFLER/CARBURETOR/CRANKCASE)**

Diagram Reference Number	Part Description	Part Number
1	SCREW	530015880
2	BOLT-MUFFLER	530058982
3	ASSEMBLY-MUFFLER/SHIELD (INCL. 2)	530057863
4	SCREW-CYLINDER	530015953
5	SPARK PLUG (RCJ 6Y) (CHAMPION)	N/P
6	CYLINDER	530012541
7	SEAL-CYLINDER (KIT)	530071750
8	KIT-PISTON/ROD ASSEMBLY (INCL. 9 & 12)	530071785
9	ASSEMBLY-CONN. ROD	530069945
10	PISTON RING	530055120
11	RETAINER-PISTON PIN	530015162
12	KIT-PISTON (INCL. 10,11)	530071833
13	SEAL-CYL./CARB. (KIT)	530071750
14	ADAPTER-CARB.	530057547
15	SCREW	530016441
16	GASKET-CARB. (KIT)	530071750
17	KIT-CARB. (C1U-W19) (NOTE: REPAIR KITS ARE NOT AVAIL.	530071811
18	AIR BOX	530059246
19	SCREW	530016429
20	FOAM-AIR FILTER	530036575
21	COVER-AIR BOX	530057545
22	IGNITION MODULE	530035505
23	SCREW	530016357
24	ASSEMBLY-SWITCH WIRE	545015601
25	SPRING-STARTER	545054901
26	ASSEMBLY-FAN HSG	545015803
27	SCREW	530015810
28	HANDLE-STARTER	530054834
29	KIT-ROPE	545050409
30	ASSEMBLY-CLUTCH	530055122
31	WASHER-CLUTCH	530094189
32	SCREW	530015772
33	SCREW	530015814
34	KIT-PULLEY-STARTER	545050407
35	BAFFLE-FAN	545080601
36	SCREW-BAFFLE	530015880
37	SPACER	530059758
38	WASHER	530016463
39	ASSEMBLY-FLYWHEEL	530039243
40	ASSEMBLY-C'CASE/C'SHAFT (INCL. 41,42,46)	530071951
41	ASSEMBLY-CRANKCASE (INCL. 43,44,45)	530012582
42	RETAIN. RING-C'SHAFT	530015941
43	OUTER BEARING	530055728
44	SEAL-C'CASE	530019264
45	INNER BEARING	530032125
46	ASSEMBLY-CRANKSHAFT	530012579
47	O-RING-C'CASE (KIT)	530071750
48	ASSEMBLY-PLUG (INCL. 47)	530057954
49	SCREW	530016386
50	SHROUD-REAR	530057539
51	RETAINER-TANK	530016445
52	ASSEMBLY-FUEL TANK (INCL. FILTER, LINES & FUEL CAP)	545103702
53	ASSEMBLY-FUEL CAP	530057973
54	KIT-FUEL LINE (SMALL)	530069247
55	KIT-FUEL LINE (LARGE)	530069216
56	ASSEMBLY-FUEL PICKUP	530095646
57	KIT-ENGINE GASKET (INCL. 7,13,16,47)	530071750
58	ASSEMBLY-CLUTCH DRUM	530150247

59	ASSEMBLY-CLUTCH COVER (INCL. 61,62)	530059757
60	SCREW	530015772
61	SCREW	530016381
62	NUT-#12-24	530016382
NI01	OPERATOR MANUAL	545137205
NI02	DECAL-SHAFT WRANING	530057296
NI03	DECAL-WRANING	530056220
NI04	BULB-PURGE	530058709